

50-S-58 - SPEEDLINE System Data Sheet - Version V1 (24-10-23)

SPEEDLINE 50mm 'C' Stud Partition @600mm Ctrs,
with 2x Siniat GTEC 15mm Standard Board each
side

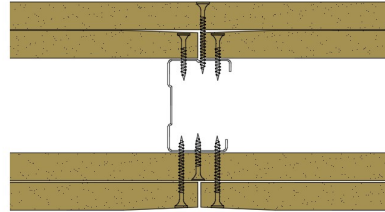

System Performance Breakdown

Fire Resistance:

BS476 Part 22:1987:

Test Ref & Date or Applied Ref & Report:

Max Height:

Thickness:

Duty Grade: BS 5234: Part 2:1992:

Sound Insulation:

60/60 Minutes (Integrity/Insulation).

- **BRE Report P102396-1011C**

Refer to Speedline Specification Clause

112 mm. (At Base Track, Excluding Finishes)

Severe - Annexes A-F

42 R_w dB, Date Tested or Assessed Against - 50-S-57

Test Code:
H17501AA
Test Date:
26/07/2011

Freq. Hz	R dB
50	22.2
63	16.3
80	12.6
100	12.6
125	16.6
160	27.1
200	30.7
250	31.0
315	34.9
400	41.1
500	46.8
630	48.0
800	51.4
1 000	52.5
1 250	55.4
1 600	58.3
2 000	57.4
2 500	47.3
3 150	45.8
4 000	50.3
5 000	52.0
6 300	
8 000	
10 000	

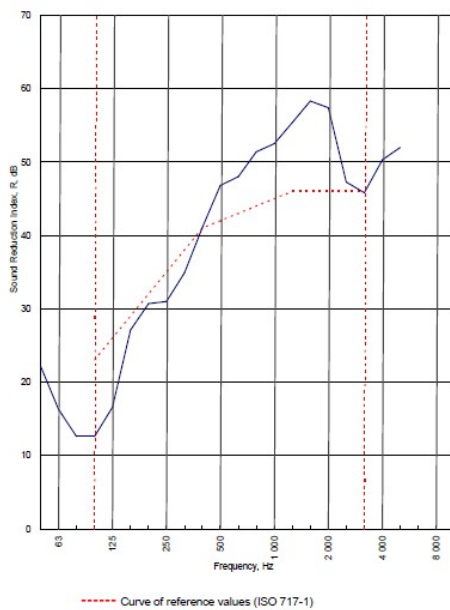

Rating according to BS EN ISO 717-1:1997
 R_w (C;Ctr) = 42 (-4;-11) dB
Max dev. 10.4 dB at 100 Hz

Evaluation based on laboratory measurement results obtained by an engineering method:

$C_{50-3150}$ = -5 dB	$C_{50-5000}$ = -4 dB	$C_{100-5000}$ = -3 dB
$C_{1,50-3150}$ = -14 dB	$C_{1,50-5000}$ = -14 dB	$C_{1,100-5000}$ = -11 dB

TESTED AT ONE OF THE UKAS ACCREDITED LABORATORIES BELOW

B.T.C (H-Ref on Graph)

B.R.E

AIRO

S.R.L

Customer: Metsec plc Hepsec Division



BTC 17501A: Page 8 of 10

SPEEDLINE Drywall Systems, Adsetts House, 16 Europa View, Sheffield Business Park, Sheffield, S9 1XH.

Tel: 0114 231 8030.

Email: enquiries@speedlinedrywall.co.uk

(As per the requirements set out in ISO/IEC 17025:2017 regarding test data the results stated have been carried out by voestalpine Metsec plc as part of the contract to supply Speedline Metal Sections to SIG Plc)